

LOGAN COUNTY, OHIO
 LOGAN-UNION-CHAMPAIGN REGIONAL PLANNING COMMISSION

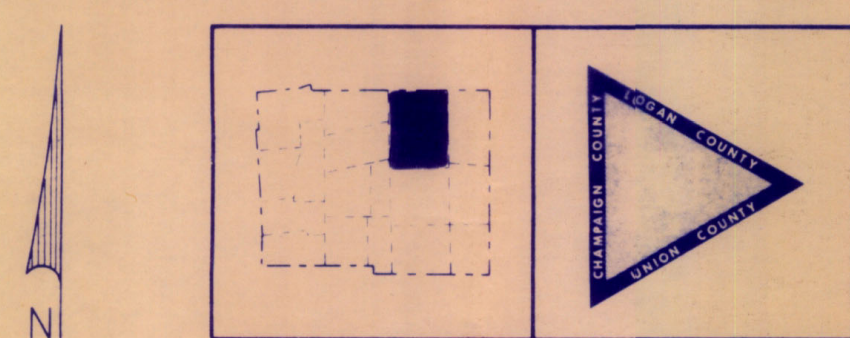
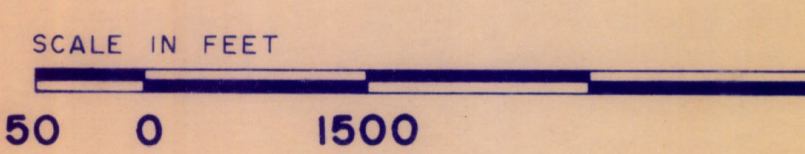

RUSHCREEK TOWNSHIP

ZONING DISTRICTS

- U-1 RURAL
- R-1 LOW DENSITY RESIDENTIAL
- B-1 SERVICE BUSINESS
- M-1 LIGHT MANUFACTURING

THIS IS TO CERTIFY THAT THIS IS THE OFFICIAL ZONING MAP REFERRED TO IN THE ZONING RESOLUTION OF RUSHCREEK TOWNSHIP, LOGAN COUNTY, OHIO.

Robert P. Smith
 chairman, township trustees

Kathleen Steinhoff
 clerk, township trustees

September 4, 1990
 date adopted